

Speed. Confidence. Safety.



Frequently Asked Questions: Basic Cable & Wire Tracing.

Kurth Electronic makes test equipment to make the installation and maintenance of cabling systems quick and easy. These test sets can help trace and troubleshoot:

- Coax
- Telephone Cable
- LAN Cable
- Fiber-optic Cable (KE801 Laser Tracer™).



WHAT ARE TONE & PROBE KITS USED FOR?

They are used to follow the path of cables and identify the opposite ends of individual cables or wires. They can:

- Help identify connected pairs of modular jacks,
- Help follow the path of a cable hidden behind walls and ceilings,
- Check for shorts and voltage in cables,
- Verify that there is phone or data service in a jack,
- Sort individual cable wires that are not color coded.

Power cables need to be de-energized -- live power circuits can damage both users and the equipment.

WHAT THINGS DO I NEED FOR TRACING?

Tracing is done using a tone generator and a sensing probe. The KE301, KE701 and KE801 kits from Kurth Electronic contain both items in a handy storage pouch.

HOW DO I DO THE ACTUAL TRACING?

To identify specific wires in a cable place tone on the wires being traced using the tone generator's alligator clips or modular plug, then use sweeping motions of the tracing probe to localize the tones and identify specific wires.

WHAT ABOUT TRACKING A CABLE PATH?

Connect the red tracing tone clip to a wire in the cable or to a disconnected cable shield. One wire from the generator can be connected to ground or even left unconnected. Use the probe's 'High' button to localize the cable and its path with sweeping motions to follow the strongest tone sound.

I AM HAVING TROUBLE FIGURING OUT WHICH WIRE IS THE TARGET.

It is common to find tracing tone around all of the wires the cable because it 'leaks' everywhere. It is possible to find your wire with a little practice. There are some ideas on the reverse side of this FAQ ... ↓

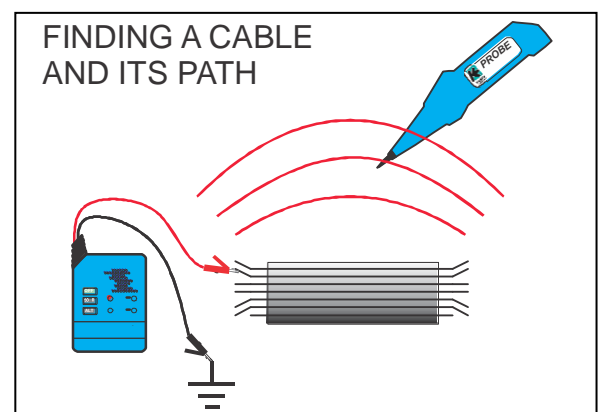
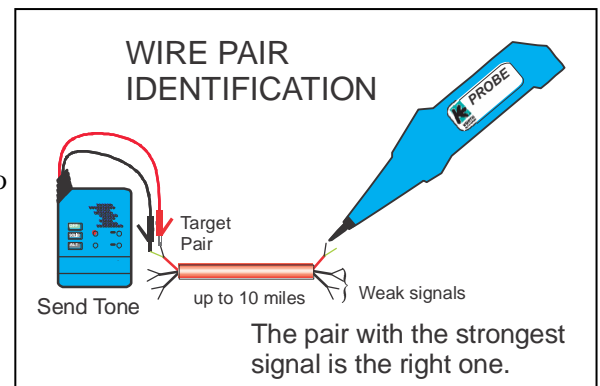

Tracing Ideas:

When tracing a single wire or identifying an entire cable simply clip the red lead to a wire.

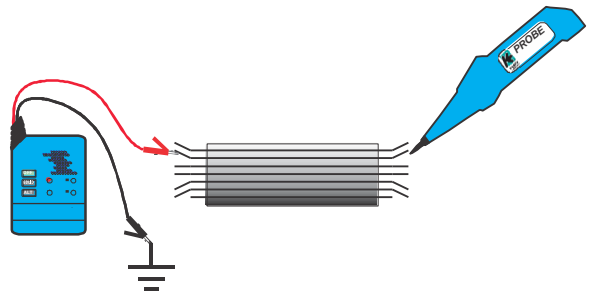

TIP: Touch the tip of the probe to each wire – this will give the best audible sign that you have the right one.

When tracing a pair of wires clip the leads to each wire, or insert the modular plug into the jack.

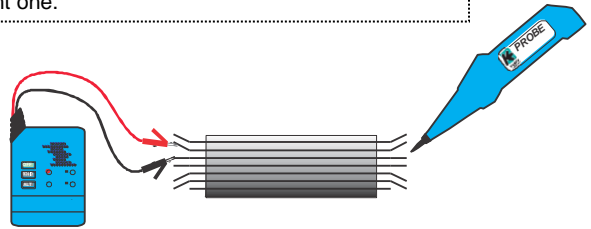

TIP: If you are working with an open pair at the far end, you will find a 'null' spot when the probe tip is between the right wires. Shorting the wires together will reduce the tone level, too.

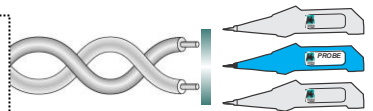

It will help to ground the other wires in the cable. This can be difficult, but makes it easier to find the traced wire.

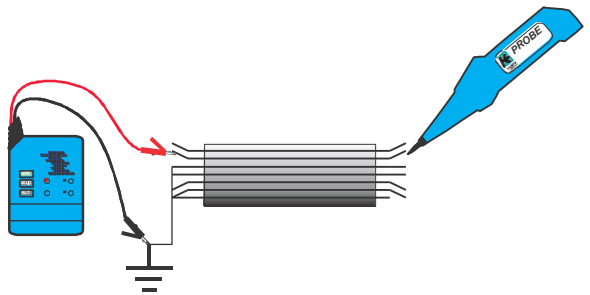

If there is still difficulty hearing the difference in tone levels, you can use the 577 Hz indicator LED to give you a visual sign. Set the tone generator to the pulsing 577 Hz trace tone.

